



11 Kingsmead Park

Allhallows Rochester ME3 9QS

Guide Price £180,000



GUIDE PRICE £180,000 - £190,000

Nestled in the picturesque Kingsmead Park in Allhallows, Rochester, this charming mobile home offers a unique opportunity for those over 50 to enjoy a peaceful and scenic lifestyle. The property boasts a nice size lounge/dinner, two comfortable bedrooms, and two convenient bathroom/shower rooms, making it a perfect retreat for those looking to downsize or enjoy a tranquil retirement.

One of the standout features of this property is the stunning far-reaching views of the farmers' fields that can be admired from the wrap-around garden. With both lawn and shingle areas, the low-maintenance garden provides the perfect setting for relaxing outdoors and enjoying the beauty of the surrounding countryside.

Residents of Kingsmead Park benefit from a sense of community and tranquillity, with the added bonus of being able to have one cat and one dog to keep them company. The manageable ground rent of £204.26 per month ensures that living here is not only enjoyable but also affordable.

For those who like to explore further afield, the convenience of having the Strood and Rochester train stations within driving distance is a definite plus. With direct services to London and the coast, the location offers the best of both worlds - a peaceful rural setting with easy access to urban amenities.

Don't miss out on the opportunity to make this mobile home your own and embrace a relaxed and idyllic lifestyle in the heart of the English countryside. COUNCIL TAX BAND A. NON TRADITIONAL TENURE. EPC exempt.



Area Map



Floor Plans

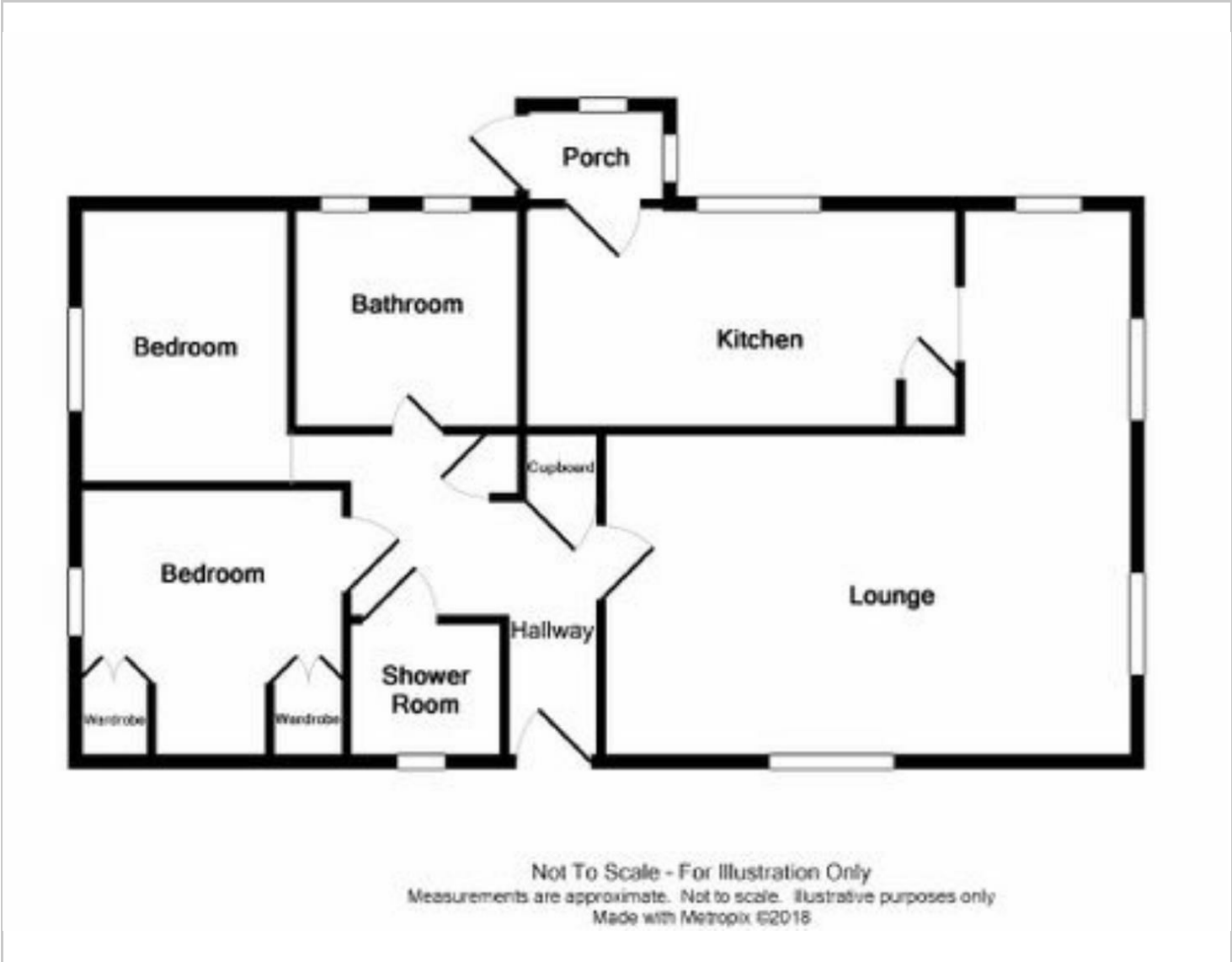

Energy Efficiency Graph

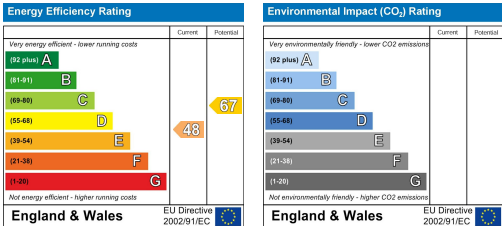

These particulars, whilst believed to be accurate are set out as a general outline only for guidance and do not constitute any part of an offer or contract. Intending purchasers should not rely on them as statements of representation of fact, but must satisfy themselves by inspection or otherwise as to their accuracy. No person in this firm's employment has the authority to make or give any representation or warranty in respect of the property.